

## TRI-SECTION PULLERS

### AP SERIES

Capacity: 4-12 Ton

### FEATURES

- The set including Tri-section plate for convenient and safe pulling job.
- Wedge-shaped edge allows removal of the most hard to grip components.
- The firm grip behind bearing's inner & outer rings ensures the pulling force not to be transmitted through the rolling parts.
- The tri-section plates design creates the most even force distribution and the maximizing spread.

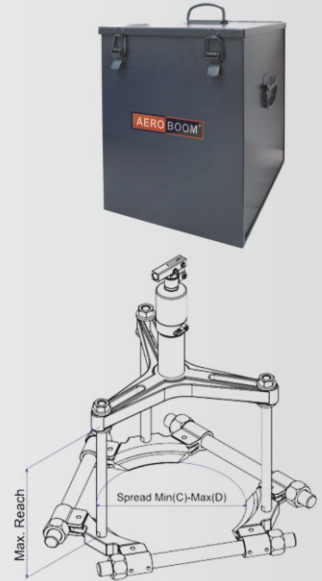

Model No.	Capacity	Reach (Max. mm)	Spread (mm)		Pump Body Model No.	Overall Width (mm)	Weight (kg)
			C (Min.)	D (Max.)			
AP3412	4 Ton	211	30	160	PM401	240	19
AP3612	6 Ton	243	50	210	PM601	285	29
AP3812	8 Ton	243	50	270	PM801	460	32
AP31212	12 Ton	284	90	340	PM1201	660	65

## TRI-SECTION PLATE

### FEATURES

- Unique & patented swivel design creates the max. spread.
- The tri-section construction provides the even force distribution, preventing bearing from locking and/or tilting on the shaft during dismantling.
- Suitable for combination usage with all three-armed hydraulic pullers.
- Available in a wide range, covering the most common shaft sizes.
- The firm grip behind inner and outer rings of bearing ensures the pulling force being transmitted through the moving parts and preventing the damaging of bearing.

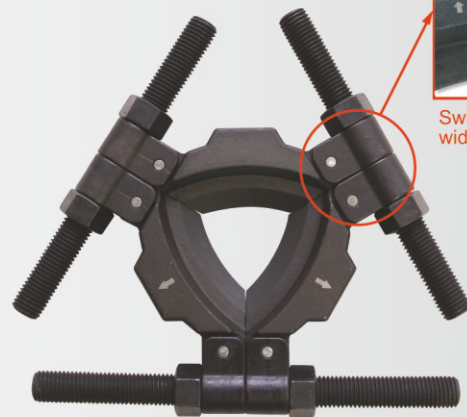

Swivel design creates wider spread.

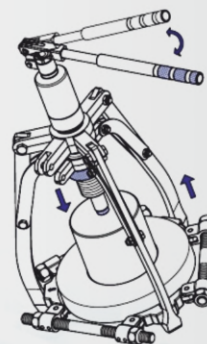
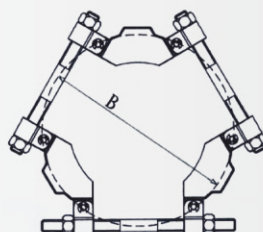
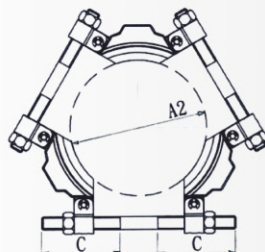
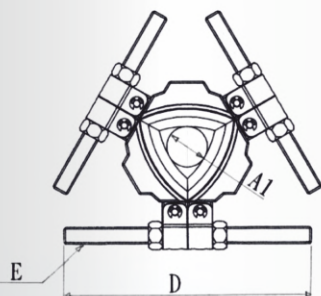

Spreading - Rear Side



Spreading - Front Side

Model No.	Available Shaft Dia.		Spread B (Max.)	C	D	E	F	G	H	Capacity (Ton)	Weight (kg)
	A1	A2									
AET3-160	26	160	216	105	240	5/8"-11UNC	8	2	6.5	6	3.5
AET3-210	50	210	280	117	285	7/8"-14UNF	10	2	9	8	5.5
AET3-340	90	340	460	175	430	1 1/4"-12UNF	14	2	8	20	18
AET3-495	140	495	660	235	610	1 3/4"-12UNF	20	2	12	30	45