

## HYDRAULIC HAND PUMP

### P SERIES

Single and Double Acting  
700 bar (10,000 psi)

### FEATURES

- High strength alloy steel construction for increased durability. Compact, easy to carry.
- All pumps are two speed design for efficient operation. Internal safety valve for overload protection.

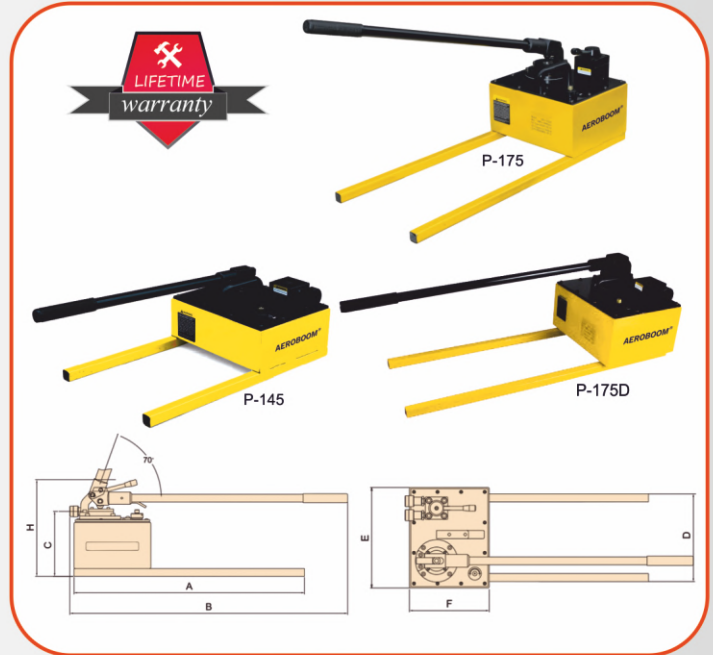

Model	Cylinder Type	Speed	Usable Oil Volume (cm <sup>3</sup> )	Pressure rating		Oil output per stroke		Handle Force (Kg)	Output Oil Thread (in)	Weight (Kg)
				1 <sup>st</sup> Stage	2 <sup>nd</sup> Stage	1 <sup>st</sup> Stage	2 <sup>nd</sup> Stage			
				(psi)	(psi)	(cm <sup>3</sup> )	(cm <sup>3</sup> )			
P-105	Single Acting	TWO	327.7	200	10,000	7.9	0.82	34.92	3/8-18NPT	2.17
P-109			737.4	360		33.4	3.3			7.28
P-123			2294.1							10.07
P-109D	Double Acting	TWO	737.4	260	10,000	26	3	50.8	3/8-18NPT	8.78
P-123D			2294.2							11.57
P-145	Single Acting	TWO	4506.4	260	10,000	26	3	50.8	3/8-18NPT	22.45
P-175	Single Acting	TWO	7505.3	260	10,000	124.5	5.7	50.8	3/8-18NPT	29.9
P-145D	Double Acting	TWO	4506.4	260	10,000	26	3	50.8	3/8-18NPT	22.45
P-175D	Double Acting	TWO	7505.3	260	10,000	124.5	5.7	50.8	3/8-18NPT	29.9

Model	A	B	C	D	E	F	G	H
	(mm)	(mm)	(mm)	(mm)	(mm)	(mm)	(mm)	(mm)
P-105	374.4	289.6	/	79.8	109.2	66.8	/	142.2
P-109	581.4	504.7	47	107.7	129.6	81.8	81.8	165.1
P-123	737.6	507		124.7	137.1	/		161
P-109D	581.4	504.7	29	107.7	106.7	81.8		165.1
P-123D	737.6	507		124.7		/	161	
P-145	579.1	607	162.5	274.3	315	249	/	266.7
P-175	800	904	210.8	274.3	315	249	/	315
P-145D	579	607	162.5	274.3	315	249	/	266.7
P-175D	800	904	210.8	274.3	315	249	/	315

## FEATURES

- Internal pressure relief valve for overload protection.
- Large oil capacity, suitable for wide application.
- Two speed auto-switch reduces manpower and increase efficiency.
- Non-conductive fibre glass handle for operator safety.

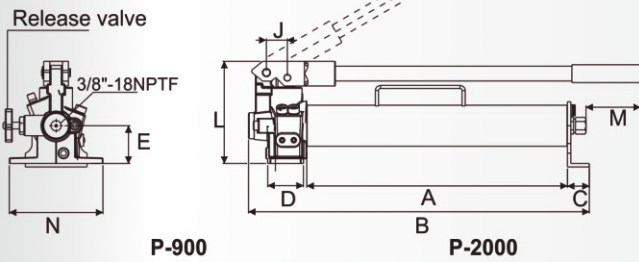

## HYDRAULIC HAND PUMP P SERIES



**Optional Features**  
To add optional features to your pump, add the follow suffixes to the end of the model number.  
**4 ways control Valve : Model D**  
**Example :**  
P-2000 with 4 ways control valve, order: P-2000D. Technical specifications for these features are available from AEROBOOM.

Model Number	Pump Type	Usable Oil Capacity (cm <sup>3</sup> )	Pressure Rating		Oil Displacement per Stroke		Piston Stroke (mm)	Dimensions(mm)								Weight (include oil) (kg)	
			1 <sup>st</sup> stage	2 <sup>nd</sup> stage	1 <sup>st</sup> stage	2 <sup>nd</sup> stage		A	B	C	D	E	J	L	M		N
			(bar)		(cm <sup>3</sup> )												
P-400	Single	400	—	700	—	1.25	22	190	292	34.0	50	50	31	139	57	140	5.0
P-900	Two-Speed	900	14	700	12.5	2.8	21	395	514	34.0	45	55	31	150	67	136	7.5
P-1200		1200	14	700	12.5	2.8	19	425	536	32.5	48	55	29	150	65	137	9.0
P-2000		2200	14	700	14.5	2.8	21	425	536	32.5	45	55	29	150	60	136	10.5
P-3000		3000	14	700	14.5	2.8	21	425	562	45.0	48	55	29	150	65	137	13.6

## FEATURES

- Internal pressure relief valve for overload protection.
- Durable glass-filled nylon reservoir and nylon encapsulated aluminum pump baser for maximum corrosion resistance.
- Two speed operation reduces handle strokes by as much as 78% over single speed pumps. Lower handle effort to minimize operator fatigue.
- Handle lock and lightweight construction for easy carrying. Non-conductive fibre glass handle for operator safety.

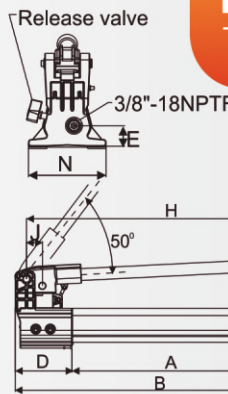

## HYDRAULIC HAND PUMP P SERIES



Model Number	Pump Type	Usable Oil Capacity (cm <sup>3</sup> )	Pressure Rating		Oil Displacement per Stroke		Max. Handle Effort (kg)	Piston Stroke (mm)	Dimensions(mm)		
			1 <sup>st</sup> stage	2 <sup>nd</sup> stage	1 <sup>st</sup> stage	2 <sup>nd</sup> stage			A	B	C
			(bar)		(cm <sup>3</sup> )						
P-392	Two-Speed	901	13	700	11.26	2.47	42.2	25.4	344	533	36
P-462		7423	14	700	126.20	4.75	50.0	38.1	210	308	163
P-464		7423	14	700	126.20	4.75	50.0	38.1	210	308	163

Model Number	Dimensions(mm)											Weight (kg)
	D	E	H	J	L	M	N	P	Q	R	S	
P-392	99	33	522	30	177	16	120	—	—	—	—	4.1
P-462	320	195	671	25	270	175	650	92	—	—	80	27.7
P-464	320	195	671	25	270	175	650	92	89	68	80	27.7